

**SUOLDaX**



Gas Products  
**CATALOGUE**

**2021**

**Guangzhou Hongzhan Catering Equipment Co.,Ltd.**

# About Us

Guangzhou Hongzhan Catering Equipment Co.,Ltd. is located in Huadu District Guangzhou, China. As a professional manufacturer of commercial kitchen equipment for western food, fast food, supermarket, snack, we undertake non-standard equipment as well. In order to satisfy the strict requirement, our factory is equipped with Laser cutting machine, CNC punching, shearing, bending and other professional processing equipment. We possess modern and standard factory buildings, advanced production lines and full series of checking and testing equipment, etc. We emphasize on product quality and excellence. At the meantime, we hope to further provide customers with more competitive and high quality products and unmatched services.



## AUTHORIZATION TO MARK

This authorizes the application of the Certification Mark(s) shown below to the models described in the Product(s) Covered section when made in accordance with the conditions set forth in this Certification Agreement and Listing Report. This authorization also applies to multiple listed model(s) identified on the correlation page of the Listing Report.

This document is the property of Intertek Testing Services and is not transferable. The certification mark(s) may be applied only at the location of the Party Authorized to Apply Mark.

<b>Applicant:</b> Guangzhou Hongzhan Catering Equipment Co., Ltd. No. 33 Xinhua Road, Shiling Town, Huadu District, Guangzhou, 510660	<b>Manufacturer:</b> Guangzhou Hongzhan Catering Equipment Co., Ltd. No. 33 Xinhua Road, Shiling Town, Huadu District, Guangzhou, 510660
<b>Country:</b> China	<b>Country:</b> China
<b>Contact:</b> Seven Guo LIU MINGSHENG 13602491838 13926259719	<b>Contact:</b> Seven Guo LIU MINGSHENG 13602491838 13926259719
<b>Phone:</b> 13602491838 13926259719	<b>Phone:</b> 13602491838 13926259719
<b>FAX:</b> NA	<b>FAX:</b> NA
<b>Email:</b> seven@suoldax.com 13926259719@163.com	<b>Email:</b> seven@suoldax.com 13926259719@163.com

**Party Authorized to Apply Mark:** Same as Manufacturer  
**Report Issuing Office:** Intertek Testing Services Shenzhen Limited Guangzhou Branch  
**Control Number:** 5016727 **Authorized by:** [Signature] for L. Matthew Smyker, Certification Manager



This document supersedes all previous Authorizations to Mark for the noted Report Number.

The authorization herein is for the use of the certification mark(s) shown below to the models described in the Product(s) Covered section when made in accordance with the conditions set forth in this Certification Agreement and Listing Report. This authorization also applies to multiple listed model(s) identified on the correlation page of the Listing Report. This document is the property of Intertek Testing Services and is not transferable. The certification mark(s) may be applied only at the location of the Party Authorized to Apply Mark.

Intertek Testing Services NA Inc.  
545 East Algonquin Road, Addison Heights, IL 60106  
Telephone 819-346-3891 or 847-439-5887 Fax 312-283-1872

<b>Standard(s):</b> Gas Food Service Equipment [ANSI Z95.11-2016 E-4]
<b>Product:</b> Gas Food Service Equipment- Gas Fryer / Stock Pot / Gas Grill / Gas Griddle / Combination Range / Gas Hoopstir
<b>Brand Name:</b> SUOLDAX
<b>Models:</b> HFRF-90A, HFRF-90B, HFRF-90C, HFRF-120A, HFRF-120B, HFRF-120C, HFRF-150A, HFRF-150B, HFRF-150C, HS-1, HS-1D, HLR-400, HLR-600, HLR-900, HLR-1200, HRC-14, HRC-24, HRC-36, HRC-48, HWRC-24, HWRC-36, HWRC-48, HLRG-400, HLRG-600, HLRG-900, HLRG-1200, HERG-24, HERG-36, HERG-48, HERG-60, HERG-24T, HERG-36T, HERG-48T, HERG-60T, HRC-24, HRC-36, HRC-48, HFSO-60-Q24, HFSO-60-Q24T, HFSO-36-Q24, HFSO-36-Q12, HFSO-60, HFSO-36, HFSO-24, HS-2, HS-4, HS-8, HWS-2, HWS-4, HWS-6



## AUTHORIZATION TO MARK

This authorizes the application of the Certification Mark(s) shown below to the models described in the Product(s) Covered section when made in accordance with the conditions set forth in this Certification Agreement and Listing Report. This authorization also applies to multiple listed model(s) identified on the correlation page of the Listing Report.

This document is the property of Intertek Testing Services and is not transferable. The certification mark(s) may be applied only at the location of the Party Authorized to Apply Mark.

<b>Applicant:</b> Guangzhou Hongzhan Catering Equipment Co., Ltd. No. 33 Xinhua Road, Shiling Town, Huadu District, Guangzhou, 510660	<b>Manufacturer:</b> Guangzhou Hongzhan Catering Equipment Co., Ltd. No. 33 Xinhua Road, Shiling Town, Huadu District, Guangzhou, 510660
<b>Country:</b> China	<b>Country:</b> China
<b>Contact:</b> Seven Guo LIU MINGSHENG 13602491838 13926259719	<b>Contact:</b> Seven Guo LIU MINGSHENG 13602491838 13926259719
<b>Phone:</b> 13602491838 13926259719	<b>Phone:</b> 13602491838 13926259719
<b>FAX:</b> NA	<b>FAX:</b> NA
<b>Email:</b> seven@suoldax.com 13926259719@163.com	<b>Email:</b> seven@suoldax.com 13926259719@163.com

**Party Authorized to Apply Mark:** Same as Manufacturer  
**Report Issuing Office:** Intertek Testing Services Shenzhen Limited Guangzhou Branch  
**Control Number:** 5016727 **Authorized by:** [Signature] for L. Matthew Smyker, Certification Manager



This document supersedes all previous Authorizations to Mark for the noted Report Number.

The authorization herein is for the use of the certification mark(s) shown below to the models described in the Product(s) Covered section when made in accordance with the conditions set forth in this Certification Agreement and Listing Report. This authorization also applies to multiple listed model(s) identified on the correlation page of the Listing Report. This document is the property of Intertek Testing Services and is not transferable. The certification mark(s) may be applied only at the location of the Party Authorized to Apply Mark.

Intertek Testing Services NA Inc.  
545 East Algonquin Road, Addison Heights, IL 60106  
Telephone 819-346-3891 or 847-439-5887 Fax 312-283-1872

<b>Standard(s):</b> Commercial cooking, rethermalization, and powered hot food holding and transportation equipment [NSF 4-2019]
<b>Product:</b> Gas Food Service Equipment- Gas Fryer / Stock Pot / Gas Grill / Gas Griddle / Combination Range / Gas Hoopstir
<b>Brand Name:</b> SUOLDAX
<b>Models:</b> HFRF-90A, HFRF-90B, HFRF-90C, HFRF-120A, HFRF-120B, HFRF-120C, HFRF-150A, HFRF-150B, HFRF-150C, HS-1, HS-1D, HLR-400, HLR-600, HLR-900, HLR-1200, HRC-14, HRC-24, HRC-36, HRC-48, HWRC-24, HWRC-36, HWRC-48, HLRG-400, HLRG-600, HLRG-900, HLRG-1200, HERG-24, HERG-36, HERG-48, HERG-60, HERG-24T, HERG-36T, HERG-48T, HERG-60T, HRC-24, HRC-36, HRC-48, HFSO-60-Q24, HFSO-60-Q24T, HFSO-36-Q24, HFSO-36-Q12, HFSO-60, HFSO-36, HFSO-24, HS-2, HS-4, HS-8, HWS-2, HWS-4, HWS-6

# Catalogue

## **Gas Fryer Series 01**

Gas Fryer.....	01
----------------	----

## **Gas Range Series 03**

Gas Range.....	04
Gas Range/Griddle Combos.....	07
Gas Range/Griddle/Salamander Combos.....	10

## **Heavy Duty Series 11**

Gas Stock Pot.....	12
Gas Countertop Griddle.....	14
Gas Countertop Charbroiler.....	15

# GAS FRYER





## HFRF-90/HFRF-120 HFRF-150

### Gas Fryer

### Features

- Key components have CSA / ETL certificate.
- 6" adjustable stainless steel legs can be removed when packing to reduce transportation cost.
- Adjustable thermostat from 200 ℉ -400 ℉.

#### HFRF-90

Size(W\*D\*H): 395X765X1162mm  
 Size(W\*D\*H): 15.57"X30.12"X45.75"  
 N.W. : 61kg G.W. : 73kg  
 Gas consumption(m<sup>3</sup>/h):  
 NG: 2.367 / LPG: 1.02

Capacity: 18.5-23L  
 Quantity of Fryer Baskets: 2  
 Quantity of Tube Burners: 3  
 Power(BTU): 30,000X3

#### HFRF-120

Size(W\*D\*H): 395X765X1162mm  
 Size(W\*D\*H): 15.57"X30.12"X45.75"  
 N.W. : 66kg G.W. : 78kg  
 Gas consumption(m<sup>3</sup>/h):  
 NG: 3.156 / LPG: 1.36

Capacity: 21.3-25L  
 Quantity of Fryer Baskets: 2  
 Quantity of Tube Burners: 4  
 Power(BTU): 30,000X4

#### HFRF-150

Size(W\*D\*H): 533X765X1162mm  
 Size(W\*D\*H): 21"X30.12"X45.75"  
 N.W. : 75kg G.W. : 93kg  
 Gas consumption(m<sup>3</sup>/h):  
 NG: 3.946 / LPG: 1.7

Capacity: 31-37L  
 Quantity of Fryer Baskets: 2  
 Quantity of Tube Burners: 5  
 Power(BTU): 30,000X5



\* All above parameters for reference only, take practicality as standard.

# Gas Range





## HFSO-24 Gas Range

### Features

- Key components have CSA / ETL certificate.
- 6" adjustable stainless steel legs and back shelf can be removed when packing to reduce transportation cost.
- Equipped with regulator.
- Gas convert kit to exchange the gas type.
- Heavy-duty cast iron lift-off grates for easy cleaning.
- Adjustable thermostat from 250°F-550°F.

Size(W\*D\*H): 610X827X1532mm  
 Size(W\*D\*H): 24"X32.67"X60.33"  
 N.W. : 129kg G.W. : 161.5kg  
 Gas consumption(m<sup>3</sup>/h):  
 NG: 3.946 / LPG: 1.699

Quantity of Burners: 4  
 Quantity of Controls: 5  
 Quantity of Racks: 2  
 Burner Power(BTU): 30,000X4  
 Oven Power(BTU) :30,000X1  
 Total Power(BTU): 150,000

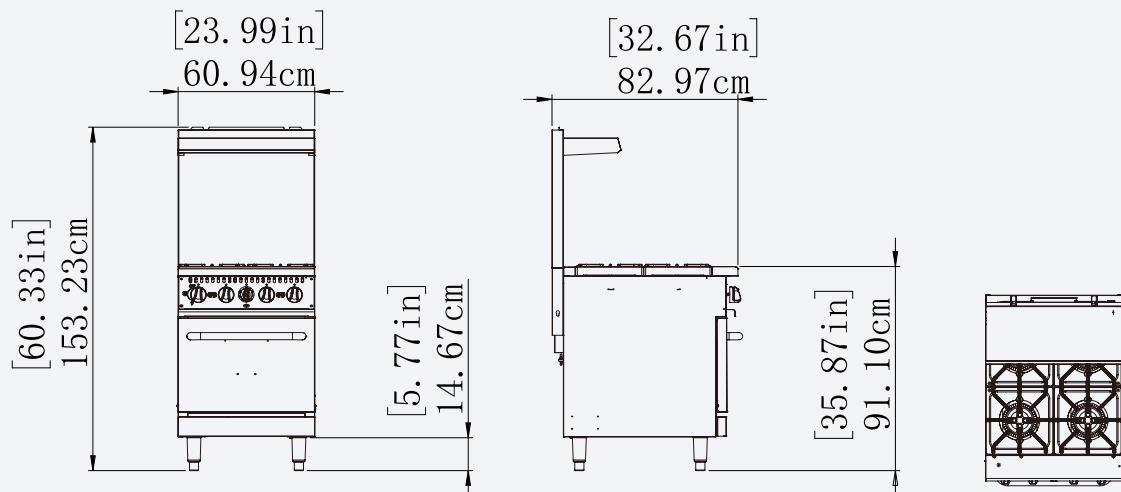

\* All above parameters for reference only, take practicality as standard.



## HFSO-36

### Gas Range

### Features

- Key components have CSA / ETL certificate.
- 6" adjustable stainless steel legs and back shelf can be removed when packing to reduce transportation cost.
- Equipped with regulator.
- Gas convert kit to exchange the gas type.
- Heavy-duty cast iron lift-off grates for easy cleaning.
- Adjustable thermostat from 250°F-550°F.

Size(W\*D\*H): 915X827X1532mm  
 Size(W\*D\*H): 36"X32.67"X60.33"  
 N.W. : 170kg G.W. : 204kg  
 Gas consumption(m<sup>3</sup>/h):  
 NG: 5.524 / LPG: 2.379

Quantity of Burners: 6  
 Quantity of Controls: 7  
 Quantity of Racks: 2  
 Burner Power(BTU): 30,000X6  
 Oven Power(BTU): 30,000X1  
 Total Power(BTU): 210,000

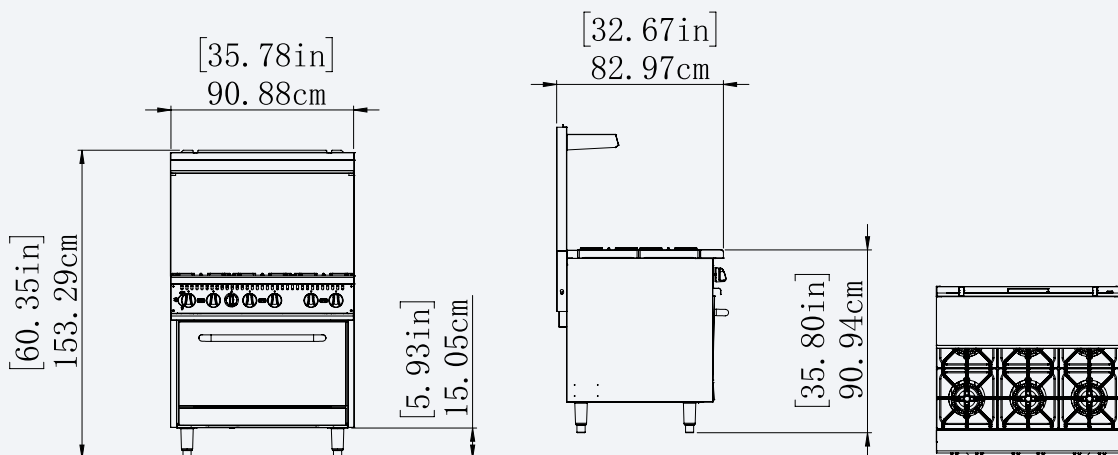

\* All above parameters for reference only, take practicality as standard.





## HFSO-36-G12

### Gas Range/Griddle Combos

#### Features

- Key components have CSA / ETL certificate.
- 6" adjustable stainless steel legs and back shelf can be removed when packing to reduce transportation cost.
- Equipped with regulator.
- Gas convert kit to exchange the gas type.
- Heavy-duty cast iron lift-off grates for easy cleaning.
- Adjustable thermostat from 250°F-550°F.

Size(W\*D\*H): 915X827X1532mm  
 Size(W\*D\*H): 36"X32.67"X60.33"  
 N.W. : 187.5kg G.W. : 225kg  
 Gas consumption(m<sup>3</sup>/h):  
 NG: 4.472 / LPG: 1.926

Quantity of Burners: 4  
 Quantity of Controls: 5  
 Quantity of Racks: 2  
 Burner Power(BTU): 30,000X4  
 Oven Power(BTU): 30,000X1  
 Griddle Power(BTU): 20,000X1  
 Total Power(BTU):170,000

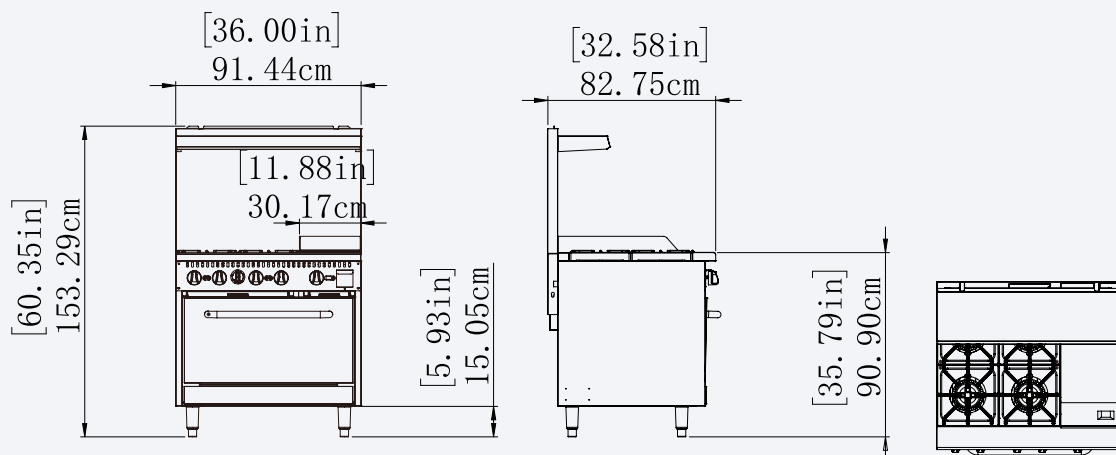

\* All above parameters for reference only, take practicality as standard.



## HFSO-60-GS24

### Gas Range/Griddle/ Salamander Combos

### Features

- Key components have CSA / ETL certificate.
- 6" adjustable stainless steel legs and back shelf can be removed when packing to reduce transportation cost.
- Equipped with regulator.
- Gas convert kit to exchange the gas type.
- Heavy-duty cast iron lift-off grates for easy cleaning.
- Adjustable thermostat from 250°F-550°F.

Size(W\*D\*H): 1524X827X1532mm  
 Size(W\*D\*H): 60"X32.67"X60.33"  
 N.W. : 331.5kg G.W. : 387kg  
 Gas consumption(m<sup>3</sup>/h):  
 NG: 7.26 / LPG: 3.127

Quantity of Burners: 6  
 Quantity of Controls: 11  
 Quantity of Racks: 4  
 Burner Power(BTU): 30,000X6  
 Oven Power(BTU): 30,000X2  
 Griddle/Salamander Power(BTU): 12,000X3  
 Total Power(BTU): 276,000

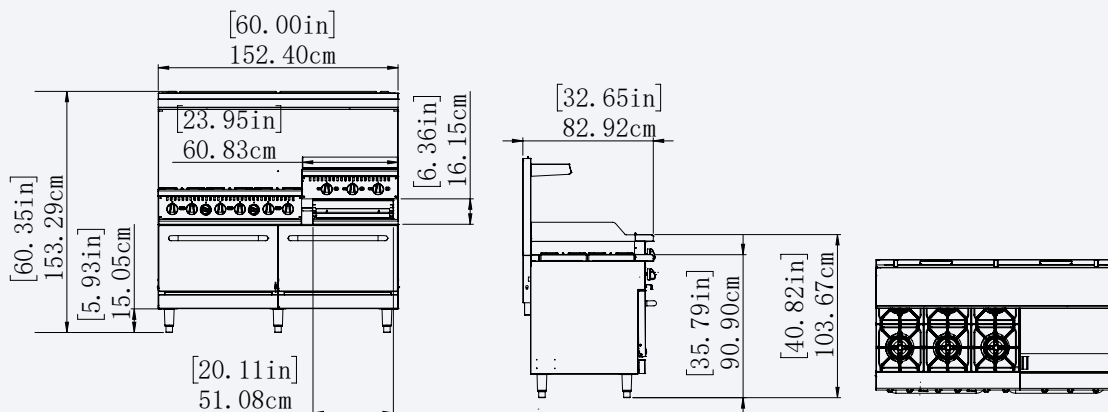

\* All above parameters for reference only, take practicality as standard.

# Heavy Duty Series





## HS-1/HS-1D

### Gas Stock Pot

#### Features

- Key components have CSA / ETL certificate.
- 6" adjustable stainless steel legs can be removed when packing to reduce transportation cost.
- Equipped with 3/4" inlet gas pipe and regulator.
- Gas convert kit to exchange the gas type.
- Heavy-duty cast iron lift-off grates for easy cleaning.
- Heavy Duty.

#### HS-1

Size(W\*D\*H): 460X550X502mm  
 Size(W\*D\*H): 18.11"X20.01"X19.75"  
 N.W. : 44kg G.W. : 52kg  
 Gas consumption(m<sup>3</sup>/h):  
 NG: 1.999 / LPG: 1.315

Quantity of Burners: 1  
 Quantity of Controls: 2  
 Power(BTU):  
 NG: 76,000X1 / LPG:50,000X1

#### HS-1D

Size(W\*D\*H): 460X1085X549mm  
 Size(W\*D\*H): 18.11"X41.98"X21.32"  
 N.W. : G.W. :  
 Gas consumption(m<sup>3</sup>/h):  
 NG: 3.998 / LPG: 2.630

Quantity of Burners: 2  
 Quantity of Controls: 2  
 Power(BTU):  
 NG: 76,000X2 / LPG: 50,000X2

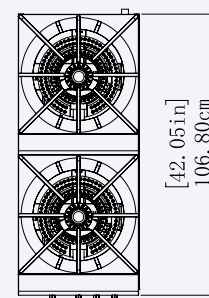
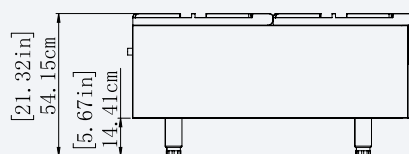
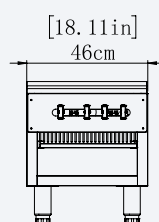

\* All above parameters for reference only, take practicality as standard.



## HS-2/HS-4/HS-6

### Gas Stock Pot

#### Features

- Key components have CSA / ETL certificate.
- 4" adjustable stainless steel legs can be removed when packing to reduce transportation cost.
- Equipped with 3/4" inlet gas pipe and regulator.
- Gas convert kit to exchange the gas type.
- Heavy-duty cast iron lift-off grates for easy cleaning.
- Heavy Duty.

#### HS-2

Size(W\*D\*H): 303X802X365mm  
 Size(W\*D\*H): 12"X31.58"X14.35"  
 N.W. : 30kg G.W. : 45.5kg  
 Gas consumption(m<sup>3</sup>/h):  
 NG: 1.578 / LPG: 0.68

Quantity of Burners: 2  
 Quantity of Controls: 2  
 Power(BTU): 30,000X2

#### HS-4

Size(W\*D\*H): 603X802X365mm  
 Size(W\*D\*H): 24"X31.58"X14.35"  
 N.W. : 54.5kg G.W. : 69.5kg  
 Gas consumption(m<sup>3</sup>/h):  
 NG: 3.156 / LPG: 1.36

Quantity of Burners: 4  
 Quantity of Controls: 4  
 Power(BTU): 30,000X4

#### HS-6

Size(W\*D\*H): 903X802X365mm  
 Size(W\*D\*H): 36"X31.58"X14.35"  
 N.W. : 84kg G.W. : 102kg  
 Gas consumption(m<sup>3</sup>/h):  
 NG: 4.735 / LPG: 2.04

Quantity of Burners: 6  
 Quantity of Controls: 6  
 Power(BTU): 30,000X6



\* All above parameters for reference only, take practicality as standard.



## HRG-24/HRG-36/HRG-48 Gas Countertop Griddle

### Features

- Key components have CSA / ETL certificate.
- 4" adjustable stainless steel legs can be removed when packing to reduce transportation cost.
- Equipped with regulator.
- Gas convert kit to exchange the gas type.
- Heavy Duty.

#### HRG-24

Size(W\*D\*H): 612X836X442mm  
 Size(W\*D\*H): 24.11"X32.93"X17.39"  
 N.W. : 91kg G.W. : 107kg  
 Gas consumption(m<sup>3</sup>/h):  
 NG: 1.578 / LPG: 0.68

Quantity of Burners: 2  
 Quantity of Controls: 2  
 Cooking Surface: 23.86"X24.09"  
 Plate Thickness: 20mm,0.79"  
 Power(BTU): 30,000X2

#### HRG-36

Size(W\*D\*H): 917X836X442mm  
 Size(W\*D\*H): 36.11"X32.93"X17.39"  
 N.W. : 129kg G.W. : 154kg  
 Gas consumption(m<sup>3</sup>/h):  
 NG: 2.367 / LPG: 1.02

Quantity of Burners: 3  
 Quantity of Controls: 3  
 Cooking Surface: 35.87"X24.09"  
 Plate Thickness: 20mm,0.79"  
 Power(BTU): 30,000X3

#### HRG-48

Size(W\*D\*H): 1222X836X442mm  
 Size(W\*D\*H): 48.11"X32.93"X17.39"  
 N.W. : 169kg G.W. : 204kg  
 Gas consumption(m<sup>3</sup>/h):  
 NG: 3.156 / LPG: 1.36

Quantity of Burners: 4  
 Quantity of Controls: 4  
 Cooking Surface: 47.87"X24.09"  
 Plate Thickness: 20mm,0.79"  
 Power(BTU): 30,000X4



\* All above parameters for reference only, take practicality as standard.



## HRC-14/HRC-24

### Gas Countertop Charbroiler

#### Features

- Key components have CSA / ETL certificate.
- 4" adjustable stainless steel legs can be removed when packing to reduce transportation cost.
- Equipped with regulator.
- Gas convert kit to exchange the gas type.
- Cast iron grill grates are reversible and height adjustable.
- Heavy Duty.

#### HRC-14

Size(W\*D\*H): 356X774X469mm  
 Size(W\*D\*H): 14"X30.47"X18.46"  
 N.W. : 58kg G.W. : 60kg  
 Gas consumption(m<sup>3</sup>/h):  
 NG: 1.052 / LPG: 0.453

Quantity of Burners: 2  
 Quantity of Controls: 2  
 Power(BTU): 20,000X2

#### HRC-24

Size(W\*D\*H): 610X774X469mm  
 Size(W\*D\*H): 24"X30.47"X18.46"  
 N.W. : 90kg G.W. : 116kg  
 Gas consumption(m<sup>3</sup>/h):  
 NG: 2.104 / LPG: 0.906

Quantity of Burners: 4  
 Quantity of Controls: 4  
 Power(BTU): 20,000X4

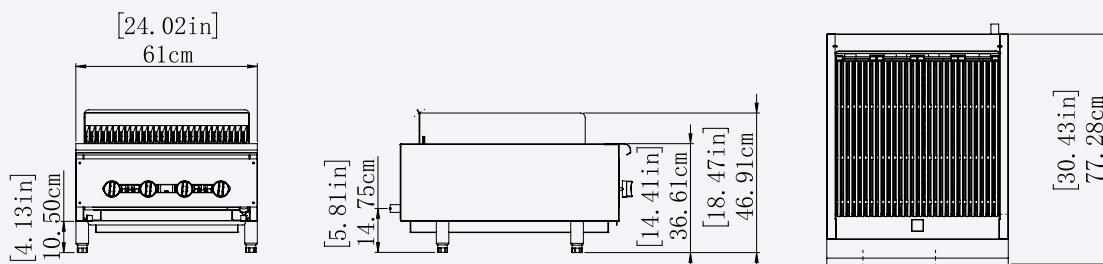

\* All above parameters for reference only, take practicality as standard.

## HRC-36/HRC-48

### Gas Countertop Charbroiler



### Features

- Key components have CSA / ETL certificate.
- 4" adjustable stainless steel legs can be removed when packing to reduce transportation cost.
- Equipped with regulator.
- Gas convert kit to exchange the gas type.
- Cast iron grill grates are reversible and height adjustable.
- Heavy Duty.

#### HRC-36

Size(W\*D\*H): 915X774X469mm  
 Size(W\*D\*H): 36"X30.47"X18.46"  
 N.W. : 138kg G.W. : 165kg  
 Gas consumption(m<sup>3</sup>/h):  
 NG: 3.156 / LPG: 1.36

Quantity of Burners: 6  
 Quantity of Controls: 6  
 Power(BTU): 20,000X6

#### HRC-48

Size(W\*D\*H): 1223X774X469mm  
 Size(W\*D\*H): 48"X30.47"X18.46"  
 N.W. : 178kg G.W. : 208kg  
 Gas consumption(m<sup>3</sup>/h):  
 NG: 4.208 / LPG: 1.812

Quantity of Burners: 8  
 Quantity of Controls: 8  
 Power(BTU): 20,000X8

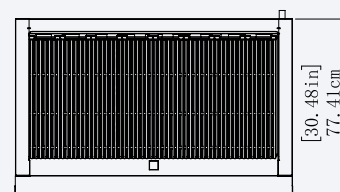
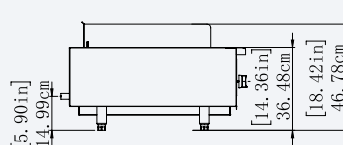
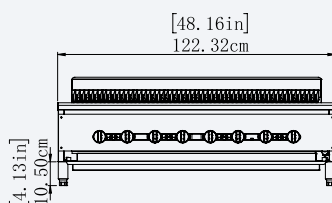

\* All above parameters for reference only, take practicality as standard.





Address: No.33 Xinhua Road, Shiling Town, Huadu District Guangzhou,  
Guangdong Province, P. R. China

E-mail: [likai@suoldax.com](mailto:likai@suoldax.com)